

Prime Ratings Range		
Genset Model	KDG0004P2	KDG0005P2
Frequency	50Hz	50Hz
kVA	3.5	5



### The Kohler Advantage

- One-stop solution for the generating system and accessories
- Manufactured in India with global expertise
- Portable generator set
- Compact design with ease of maintenance
- Flexible & creative customized solutions to meet customer needs
- Fast response time
- One-year or 2000 hours as per standard warranty terms from date of initial startup

### Special Features

- Natural aspirated, air cooled diesel engine with superior efficiency and operating economy
- Integral vibration isolation eliminates the need for under-unit vibration spring isolators
- Advanced Digital Controller (ADC) with 3 auto crank cycles
- Alternator features:
  - Alternator meets Indian and international standards
  - Self-ventilated and drip-proof of IP23 construction
  - Superior voltage waveform by 2/3 pitch wound stator
- Silencer located inside canopy
- On field convertability from manual to AMF

### Standard Features

- Engine mounted alternator
- Single - bearing alternator with insulation Class H
- Base frame mounted fuel tank with minimum 8 hrs running capacity
- Dry type air filter
- DG isolator / circuit breaker
- Electric start with battery
- Industrial grade termination
- Conveniently located fuel level indicator
- Weather proof enclosures to withstand harsh climate
- Ease of accessibility for all routine service points
- Canopy with wheels and handle

### Conformance Standards

- ISO 3046
- BS 5514
- ISO 8528
- BS EN 60034
- BS5000
- VDE 0530
- NEMA MG1-32
- IEC34
- AS1359
- CSA C22.2-100
- IS10001

### Generator Set Ratings

Genset	Engine	Alternator	Voltage	Phase	Hz	Prime Rating	
						kWe	kVA
KDG0004P2	KD441-GSI2	S16W-105	230	1	50	3.5	3.5
KDG0005P2	KD441-GSI2	ET16F-130	415	3	50	4	5
KDG0005P2	KD441-GSI2	S16W-150	230	1	50	4	5*
KDG0005P2	KD441-GSI2	ES16F-160/A	230	1	50	4	5

\* Operating up to 0.9 - 1.0 PF

PRIME POWER RATINGS: Prime power ratings apply to installations where utility power is unavailable or unreliable. At varying load, the number of generator set operating hours is unlimited. A 10% overload capacity is available for one hour in twelve. Ratings are in accordance with ISO-8528/1, overload power in accordance with ISO-3046/1 and BS 5514. For limited running time and base load ratings, consult the factory. Obtain the technical information bulletin (TIB-101) on ratings guidelines for the complete ratings definitions.

## Engine Specifications

Specifications	3.5 kVA	5 kVA
Engine model	KD441-GSI2	KD441-GSI2
Engine aspiration	Natural aspiration	Natural aspiration
No. of cylinders & arrangement	1, Vertical	1, Vertical
Displacement, L (cu. in.)	0.44 (26.85)	0.44 (26.85)
Bore and stroke, mm (in.)	86 x 76 (3.38 x 2.99)	86 x 76 (3.38 x 2.99)
Compression ratio	20.3:1	20.3:1
Governor type	Mechanical	Mechanical
Governor class	Class A2	Class A2
Frequency regulation, steady state	ISO 8528 G1	ISO 8528 G1
Air cleaner type, Qty	Dry, 1	Dry, 1
Rated speed (rpm)	3000	3000
Max. power kWm (BHP)	6.1 (8.18)	6.1 (8.18)
<b>Diesel Fuel Consumption</b>		
100% Load (Lph)	0.8	1.4
75% Load (Lph)	0.7	1
<b>Lube Oil Consumption</b>		
100% load (Lph)	0.006	0.006
<b>Fuel System</b>		
Fuel prime pump	Mechanical	Mechanical
Fuel filter : Type, Qty	External , 1	External , 1
Recommended fuel	HSD-ASTM D2	HSD-ASTM D2
Fuel tank capacity, L	15	15
Fuel filter change period	Initial - 50 hrs / 3 months, Subsequent 250 hrs / 6 months whichever is earlier	Initial - 50 hrs / 3 months, Subsequent 250 hrs / 6 months whichever is earlier
<b>Lubrication System</b>		
System type	Forced Lubrication	Forced Lubrication
Lube oil type	Kohler Oil	Kohler Oil
Oil pan capacity with filter, L	1.5	1.5
Oil filter: Quantity, Type	1, Cartridge	1, Cartridge
Oil and oil filter change period	Initial - 50 hrs / 3 months, Subsequent 250 hrs / 6 months whichever is earlier	Initial - 50 hrs / 3 months, Subsequent 250 hrs / 6 months whichever is earlier
<b>Exhaust System</b>		
Maximum allowable back pressure, KPa (in.Hg)	5 (1.48)	5 (1.48)
Exhaust outlet size at engine hookup, mm (in)	40 (1.57)	40 (1.57)
Silencer Type, Quantity	Residential, 1	Residential, 1
Exhaust temperature at rated kW, °C (°F)	550 (1022)	550 (1022)
<b>Air System</b>		
Combustion air , LPM	530	530
Heat rejected to ambient air : Generator, kW (BTU/min)	2.85 (162)	2.85 (162)
Generator set air cooling system	Blower / Fan	Blower / Fan
<b>Engine Electrical System</b>		
Starter Motor rated voltage VDC	12 V	12 V
Battery charger	12 V, 5 Amp	12 V, 5 Amp
Ground (negative/positive)	Negative	Negative
Battery type-	Lead acid	Lead acid
Battery rating (Amp-hour)	35	35
Quantity	1	1
Battery Voltage, VDC	12	12

## Alternator Specifications

Specifications	3.5 kVA	5 kVA
Type	2 Pole	2 Pole
Exciter type	Brushless	Brushless / Brush type
Voltage regulator	Capacitor	Capacitor / AVR
Insulation - Material - Temperature rise, Prime	Class H 125°C	Class H 125°C
Bearing: Quantity, Type	1, Sealed	1, Sealed
Coupling	Direct	Direct
Voltage regulation	+/-10%	+/-10% / +/-5%
Excitation	Self excitation	Self Excitation
Frequency, Fixed, Hz	50	50
Full load current - 1 Phase (Amp)	15.2	17.4 / 21.7
Full load current - 3 Phase (Amp)	--	6.9
Prime at 125° C, kVA	3.5	5

## Advanced Digital Controller (ADC2000)

### Standard Features

- Master switch: Control On/Off
- Remote two-wire start/stop capability
- One-source responsibility for generating system & accessories
- Automatic start with programmed cranking cycle
- Operating temperature: -20°C to 70°C (-4°F to 158°F)
- Storage temperature: -20°C to 70°C (-4°F to 158°F)
- Humidity: 0-95% condensing
- Control Panel
  - Alternator to control panel connection with copper cable only
  - MCCB/MCB details - with short circuit and overload protection
  - Output copper cable size : (Sq.mm x run) :

	3.5 kVA	5 kVA
1 Phase :	4	6
3 Phase :	--	2.5

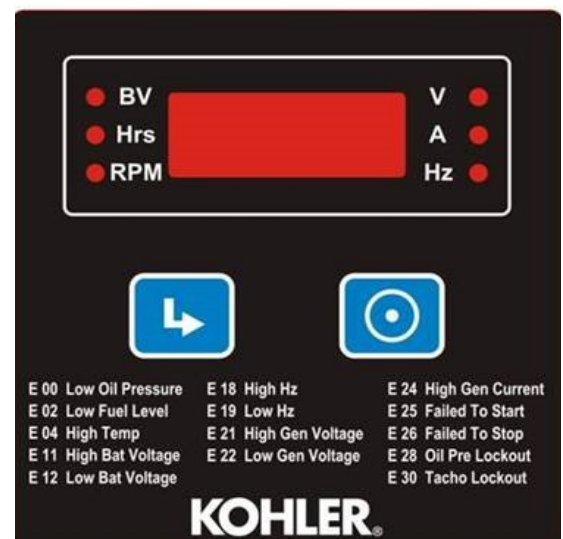

### Optional Features

- Microprocessor based AMF control panel

### Controller Information

LED Display	LED Display Faults	Display Warnings	Optional Accessories	Power Requirements
Runtime hours	High engine temperature	Low battery voltage	Mains sensing relay	8 to 16 VDC with fuse protection
Engine speed	Low oil pressure	High battery voltage	RCBO	40 mA @ 12 VDC
Battery voltage	Overspeed / underspeed			
Current	Over and under voltage			
Voltage	Over and under frequency			
Frequency	Auxiliary fault			
	Low fuel level			
	Over load current			

## Regulatory Compliance

Specifications	3.5 kVA	5 kVA
As per ISO 8178-5 mode cycle (Engine emission)	CPCB-II compliant	CPCB-II compliant
Noise level measured at 1 meter distance	< 75 dB (A)	< 75 dB (A)

## Dimensions and weight

Specifications	3.5 kVA	5 kVA
Overall Size, L x W x H (mm)	960 x 660 x 789	960 x 660 x 789
Dry weight, max (kg)	203	209

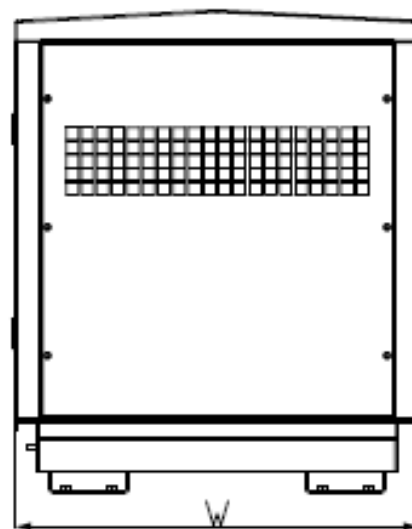
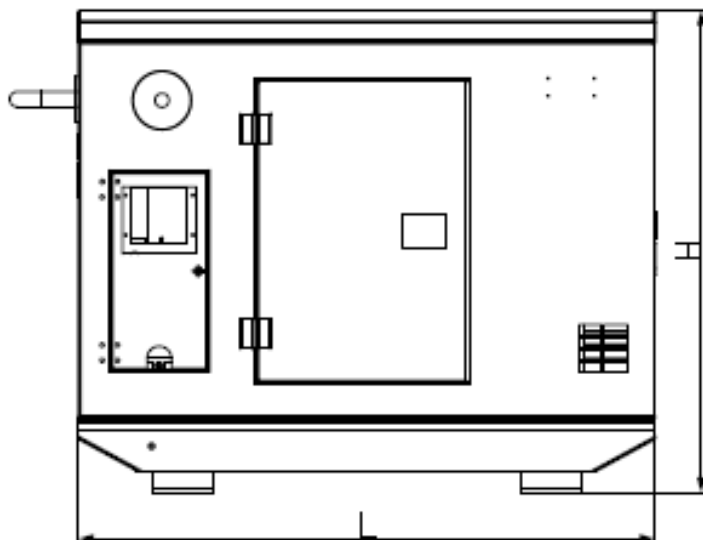

NOTE : Drawing provided is for reference only and should not be used for planning installation. Please contact the Company for latest updated details.

\* Disclaimer: Product images shown are for illustration purpose and may not be an exact representation of product.

\* All the data is as per respective manufacturers' specification. Please refer O & M manual for maintenance and preservation guidelines.

\* Fuel consumption data is based on HS Diesel having specific gravity of 0.85 and conforming to IS:1460 Standard. Fuel consumption tolerance is +5%.

KOHLER reserves the right to change the design or specifications without notice and without any obligation or liability whatsoever.

**KOHLER®**  
IN POWER. SINCE 1920.

Corporate Office :  
Kohler Power India Pvt. Ltd.,  
701 & 702, 7th Floor, Pentagon Tower P5,  
Magarpatta City, Hadapsar, Pune - 411013,  
Maharashtra, India.

Regional Offices :  
Pune : +91 20 6649 7101 | New Delhi : +91 11 4102 2919  
Kolkata : +91 33 4063 3512 | Bangalore : +91 80 4286 7000

Factory :  
Kohler Power India Pvt. Ltd.,  
(Formerly: Lombardini India Pvt. Ltd.),  
J-2/1, MIDC Chikalthana, CIDCO,  
Aurangabad - 431210, Maharashtra, India.

Authorised Channel Partner:

**ISO 9001**  
**KOHLER®**  
IN POWER. SINCE 1920.  
NATIONALLY REGISTERED  
Printed in India

© 2022 by Kohler Co.  
All rights reserved. Use of this material is strictly prohibited  
without written permission from Kohler Co.

kohlerpower.in / 1800 266 0600 / kpi.info@kohler.com / +91 95 2777 7779